

502050 Clock Guard



Specifications—502050 Clock Guard Product Description

Clock Guards, manufactured by Progressive Sports Construction Group, designed to prevent shattered glass in an activity area by shielding the clock from flying sports equipment. Heavy-duty, wall-mounted steel frame to fit over most standard size gym clocks. Constructed of $\frac{1}{4}$ " diameter, 16-gauge steel rods welded to a steel frame. Finish shall be black powder coat for years of indestructible protection for your clock. The guard's inside dimensions are 20" x 20" square. The clearance between the wall and the front of the frame measures 4". A $\frac{3}{8}$ " space lets the clock cord pass under the frame. For quick and easy access to the clock, the clock protector is double hinged on one side, with a wing-nut fastener assembly on the other. No tools are needed to open or close the guard.

Clock not included; must be provided by others.

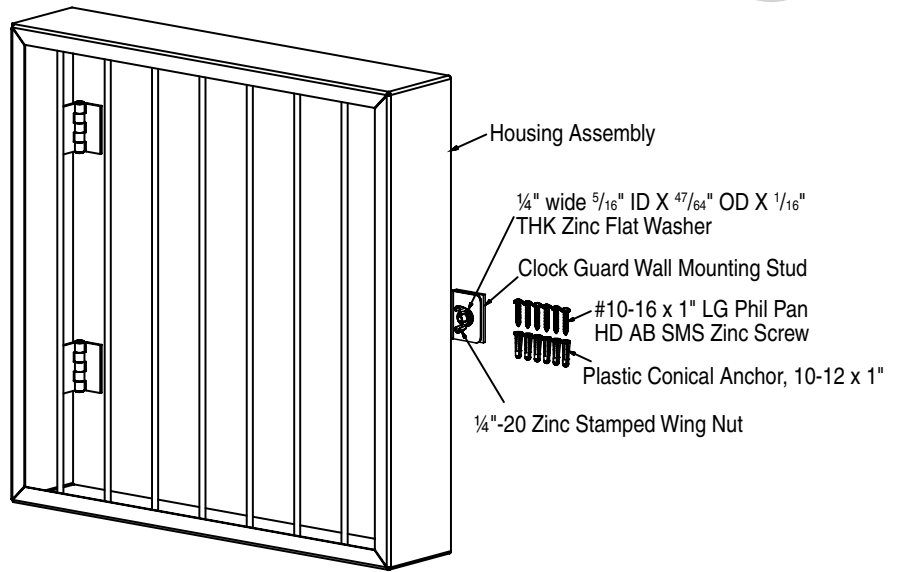

Clock not included; provided by others.

Dimensions

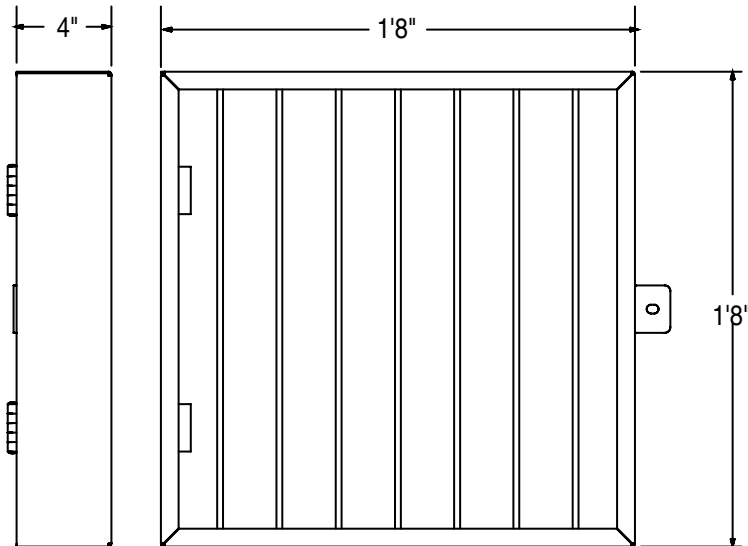

Installation Instructions

- ① Locate clock guard so it is centered over clock location.
- ② Secure to wall with six #10 screws and plastic anchors, or with other appropriate hardware to best fit exact building conditions.
- ③ Locate and secure C021.026SA Locking Plate.
- ④ Install clock and lock clock guard with wing nut (provided).

Maintenance Instructions

- ① Inspect periodically to insure all hardware and welds are secure. Repair and/or replace accordingly.

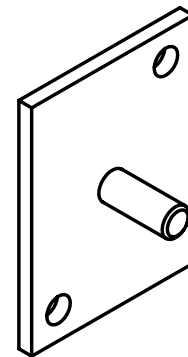

C021.026SA Locking Plate



PROJECT:	_____
ARCHITECT:	_____
CONTRACTOR:	_____
SUPPLIER:	_____
DATE:	_____
REVISED:	_____